



Double Chargeable Wearable Breast Pump

User Manual



Read this user manual carefully before using your electric breast pump, and save the user manual for future reference.

Overview

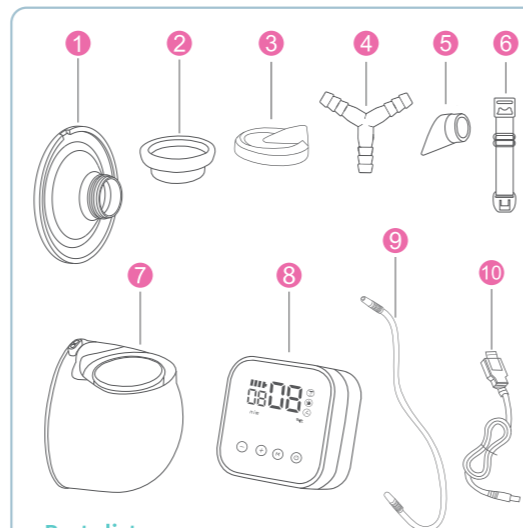

Parts list

- ① Silicone shield x2
- ② Silicone cylinder x2
- ③ Cylinder head x2
- ④ Y Connector
- ⑤ Silicone valve x2
- ⑥ Bra adjustment buckle x2
- ⑦ Milk collector x2
- ⑧ Pump
- ⑨ Flexible pipe x2
- ⑩ Cable

Control panel

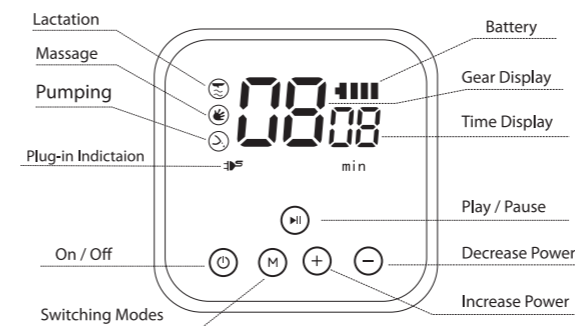

Specification

Rated Voltage	5V
Rated Power	3W
Ampere:	1A
Battery Capacity:	1200mAh
Power Adapter:	5V- 1A
Auto Power Off:	30 minutes

Assembling

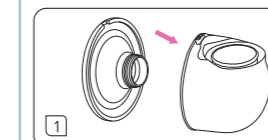

1. Put the silicone horn and bell mouth in sequence, then put in the dust shield

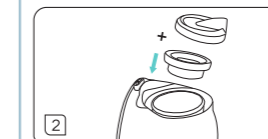

2. Put the cylinder and cylinder head into three links and tighten the cylinder head.

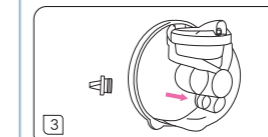

3. Put the valve into the bottom outlet of the three way to ensure that there is no leakage.

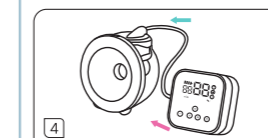

4. Insert the straight-through joint of the hose into the cylinder head and the relative hole position of the main engine to ensure that there is no air leakage and can be used.

Bra adjustment buckle

Adjust the length of bra straps, make suction more comfortable.

One end of the bra adjustment buckle hung on the inside buckle of nursing bra. The length of the bra strap can be adjusted by hanging the nursing bra buckle on the other end of the bra adjustment buckle.



Sitting position for suction

Relax the body, sit in a comfortable chair and lean slightly forward (use cushion to support back). Make sure to keep the breast pump and milk collector upright.

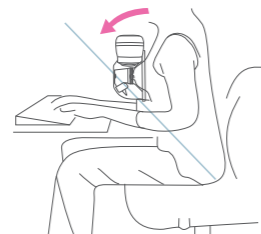

How to use:

- Press the silicone shield firmly against the breast, leaving no gap and ensuring your nipple is centered.
- Lightly press the power button to start the breast pump.
- Lightly press the "M" key to switch between modes.
- Start with the massage mode and use the "+" and "-" keys to find a comfortable power level until you notice milk drops, then switch to the pumping mode.
- Start with a low suction level and then increase the power level if needed.
- After pumping, turn off the breast pump and then carefully remove the breast pump from the breast.
- Unscrew the feeding bottle from the breast pump to prepare for nursing/storage.
- Disassemble the breast pump components and clean them according to the cleaning instructions.

Note

The machine has a memory function. When you turn it on again, the pump will automatically enter the working mode and suction level you used last time.

Cleaning and sterilizing

- For the first time and before each use, you must disassemble the pump to wash and sanitize all the parts that come into contact with the breast milk.
- Never wash or sanitize the pump motor. You can wipe this part with a clean, soft cloth.
- Clean the product with a bottle brush using warm water and mild detergent.
- It can be sanitized by putting it in hot water for 5 minutes, but be careful not to add the parts to the water while it is boiling. Let the water calm down first, then add the parts to sanitize.
- Take care when cleaning the valve and silicone diaphragm, as damage to these parts will prevent the breast pump from functioning properly.
- To clean the valve, rub it gently between your fingers in warm, soapy water. Do not insert any objects as this may cause damage.

Note

The power adapter is a common standard accessory on the market. This product is not provided. Power adapter specification: 5V= 1A.

Storing your breast milk

Storing breast milk

Store the breast milk in clean and sterilized storage bag or sealed bottle, and put them in fridge immediately.

Unfreeze breast milk

Put the frozen breast milk in the fridge to unfreeze overnight. In case of any emergency, you can defrost the milk in a bowl of hot water, make sure the bottle stand up, or bottle warmer to heat the milk quickly.

Tips 1

- Only store the breast milk collected by sterilized breast pump.
- Do not freeze the breast milk repeatedly
- Do not mix fresh breast milk with frozen breast milk
- Be sure to discard the remaining breast milk after feeding

Tips 2

- Remember! Always check the milk temperature before feeding.
- Never heat breast milk in microwave as this may destroy valuable nutrients and antibodies.
- Uneven heating may lead to local overheating of the milk, which may cause burns.
- Do not immerse a frozen bottle in boiling water to avoid crack or split.

Note

This product has a built-in lithium battery. When the battery indicator flashes in red, we recommend that you use a certified 5V= 1A adapter to charge the pump motor as soon as possible.